

J. H. FLETCHER & CO. Box 2187 – Huntington, WV 25722-2187 – 304/525-7811 – FAX 304/525-4025

IMPORTANT SAFETY NOTICE

INFORMATION BULLETIN NO. 115

TO: ALL OWNERS OF J.H. FLETCHER & CO. NEW AND MODERNIZED MACHINES PURCHASED SINCE JULY 2009

FROM: J.H. FLETCHER & CO. RISK MANAGEMENT DEPARTMENT

DATE: MARCH 2010

SUBJECT: GROMMETS USED IN MCI LIGHT PACKING GLANDS

J.H. Fletcher & Co. (Fletcher) has been notified by our vendor, Mining Controls Inc. (MCI), that the grommets used in light packing glands distributed by MCI in the time period of July 24, 2009 through November 25, 2009 may be undersized (see MCI notice – Attachment 1). MCI has initiated a voluntary recall (Attachment 1). MCI did ship these materials to Fletcher and we have identified that these gland assemblies were used in specific machines over the last year only (see Attachment 2). Also, some customers may have purchased packing gland assemblies directly from Fletcher or one of its authorized distributors and may have supplies in existing inventory. This Notice applies to owners/users of specific machines *and* to customers with 2009 packing gland assemblies inventories (bulk supplies).

In an effort to assist our customers with the MCI recall Fletcher will provide replacement grommets and washers free of charge.

Enclosed is a breakdown sheet of the light fixture to indicate the location of the grommets on the lights (see Attachment 3).

If you own or know of the location/owner of a machine affected by this recall Fletcher recommends you do the following:

1. Read the MCI recall notice thoroughly.
2. Call the Fletcher service department; provide the serial number of the machine(s) you will be replacing the grommets on. Request one kit (part no. 133243) for your entire machine. Enough grommets and washers will be provided in each free kit to repack all the MCI lights on your machine.

3. Replace the grommets and washers in each involved machine's lights. Follow the instructions provided by MCI completely (see Attachment 4). Comply with all regulations and guidelines for performing maintenance on permissible equipment. When you have replaced the grommets and washers, DESTROY the old grommets and washers in an appropriate manner so they cannot be used again. If you have purchased any packing gland assemblies as a stock item in the last year from Fletcher and/or one of its authorized distributors, please ship them back to us and we will replace the packing gland assemblies free of charge.
4. Place the updated drawing we will provide with the MCI replacement kit in your parts book with the original parts sheet.

Fletcher apologizes for the inconvenience that this recall may cause its customers. THIS RECALL ONLY AFFECTS THE MACHINES IDENTIFIED IN THIS NOTICE and customers with bulk packing gland assemblies supplies.

To maintain the permissibility of the electrical system of your bolter, we believe you should take immediate action on this issue. If you have any questions concerning this issue please do not hesitate to contact David Cooper at (304) 525-7811, ext. 240, or by email at dcooper@jhletcher.com.

NOTICE FROM MCI



MINING CONTROLS INC.

Subsidiary of Elgin National Industries, Inc.

P. O. Box 1141
Beckley, West Virginia 25801
304-252-6243
304-252-9257 fax

12-4-2009 Revised 12-11-2009

To all Mining Controls Inc. Customers
Notification & Recall

Dear MCI Customers

This notice is to inform you of a problem with grommet packing gland assemblies Shipped after July 20, 2009 and before November 1, 2009. The problem is with the material thickness of each grommet. The approved thickness of the grommet is 0.250 +/- 0.020. MSHA is aware of this and we are working together to correct the problem.

Action to be taken by MCI customers:

Options:

1. Check all grommets in stock and return bad grommets to MCI for replacement ASAP.
2. Ship all gland assemblies in your stock to MCI for inspection. MCI will check, and replace defective grommets, and return to customer.
3. If a gland assembly is being installed with incorrect grommets, it will be very clear since the gland nut will not tighten before the nut bottoms out against the housing. If this accurse when packing a gland or is found on a machine in service please check the grommets in use and contact MCI for replacement grommets.

It is my hope we can take care of this problem as soon as possible.

If you have any questions please call Larry Rowley @ 304-252-6243 ext 117

Sincerely,

A handwritten signature in black ink, appearing to read 'Larry W. Rowley', is written over a horizontal line.

Larry W. Rowley
Manager of Lighting & Camera Products
Mining Controls Inc.
304-252-6243 ext 147

ATTACHMENT 2

MACHINE LIST FOR IB 115

SERIAL NO.	ORIG. SERIAL NO.	MODEL	SERIAL NO.	ORIG. SERIAL NO.	MODEL
2008067		CHDDR	2009059		CHDDR
2008090		DDR	2009060		LTDO
2008140		RRI	2009061		LTDO
2008147		DR	2009063		DR
2008157		RRII	2009064		DR
2008158		RRII	2009068		RRII
2008159		RRII	2009069		RRII
2008166		DDR	2009070		RRII
2008172		DDR	2009074		RRII
2008185		CDR	2009075		RRII
2008348	96313/85061	LHD DRILL	2009076		DR
2008349	96314/85062	LHD TENDER	2009077		FD/LHD
2008361	97088	RRII	2009078		CHDR
2008366	97324/83070	DDO	2009081		RRII
2008370	2001241/93019	RRII	2009082		RRII
2008372	98305/91067	RRII	2009083		CHDR
2008441		HDDR	2009214	2001442/97087	RRII
2008444		RRII	2009216	2000301/94102	RRII
2008445		RRII	2009218	2001361/89110	DDO
2008446		RRII	2009219	2002027	RRII
2008477		RRII	2009222	2003004	DDR
2008479		HDDR	2009223	2002015	DDR
2008515		3885 AD	2009233	2004306/89007	RRII
2008517		3885 AD	2009238	99315/94300	RRII
2008522		3730 AD	2009239	2006020	RRII
2008526		HDR	2009301	2000039	RRII
2008527		HDR	2009303	76021	CDR
2008528		HDR	2009304	2002213/92026	RRII
2008529		HDR	2009305	2004010	RRII
2008530		HDR	2009306	99302/93044	CHDDR
2008531		3323 RD	2009309	2005301/2000034	RRII
2008706		J251-LS	2009310	2004011	RRII
2009007		DDR	2009311	85014	RRII
2009008		DDR	2009312	2008058	CHDR
2009011		CDDR	2009313	2007315/2004327	CDR
2009014		RRII	2009318	88139	LTDO
2009015		RRII	2009319	89126	LTDO
2009016		RRII	2009321	2005308/94055	CDR
2009018		RRII	2009328	2003026	DDO
2009019		RRII	2009412	2008030	CHDDR
2009032		RRII	2009413	2008031	CHDDR
2009033		RRII	2009418	2005039	DDR
2009052		CDR-D	2009421	2004130	DDR
2009053		RRII	2009422	84081	DDR
2009054		RRII	2009501		3224 AD
2009056		CHDDR	2009502		3323 RD
2009057		CHDDR	2009605	2005520	3035 AD
2009058		CHDDR	2009702		KFD

ATTACHMENT 3

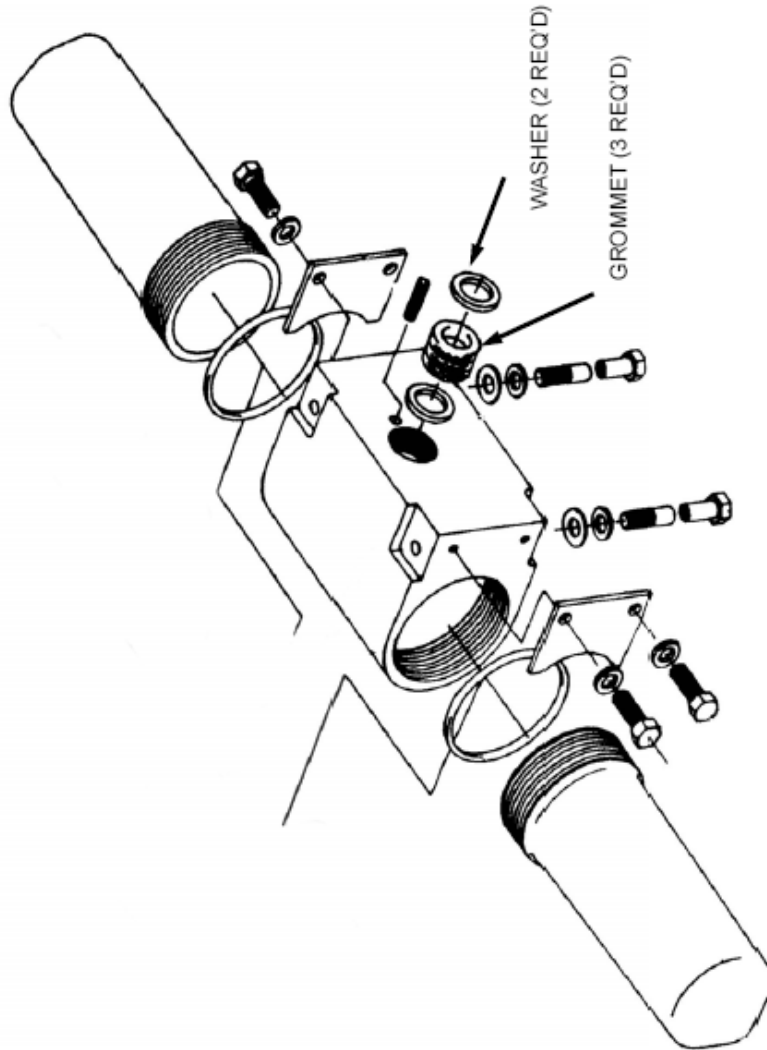

EACH KIT CONTAINS:
60 GROMMETS
40 WASHERS
1 INSTRUCTION SHEET
1 PARTS SHEET

NOTE: EACH KIT CONTAINS ENOUGH MATERIAL TO REPACK 20 GLAND ASSEMBLIES.

ATTACHMENT	133243	TITLE	DATE
3	MCI GROMMET REPLACEMENT KIT	01/28/10	



INSTRUCTIONS FROM MCI

**Mining Controls Inc. Grommet Recall
Grommet Packing Glands installed on underground equipment.**

Question: Does this gland assembly have grommets that are too thin?

To inspect the gland assembly, use the following procedure :

1. Remove the locking device i.e. (lock screw or seal wire.)
2. With your hand, tighten the gland nut.
3. Check the gap between the housing and the side of the nut closest to the housing. If the gap is less than 1/8" replace the grommets and bushing.
(CONTACT MINING CONTROLS FOR REPLACEMENT GROMMET KITS)
4. If the gap is greater than 1/8", the gland assembly is good.
5. Replace the locking device.

Note : the movement of the gland hose tube has no bearing on whether the gland is properly packed.

If you have any questions please contact:

Lynn M. Huggins, Mining Engineer, QA & MTD MSHA 304-547-2073

higgins.lynn@dol.gov

Larry W Rowley, Manager of Lighting & Camera Products, Mining Controls Inc. 304-252-6243 ext 147

larry.rowley@elginindustries.com