

# FLETCHER

## Model DDR Walk-Thru Chassis

Angle Drilling, Dual Head Roof Bolter

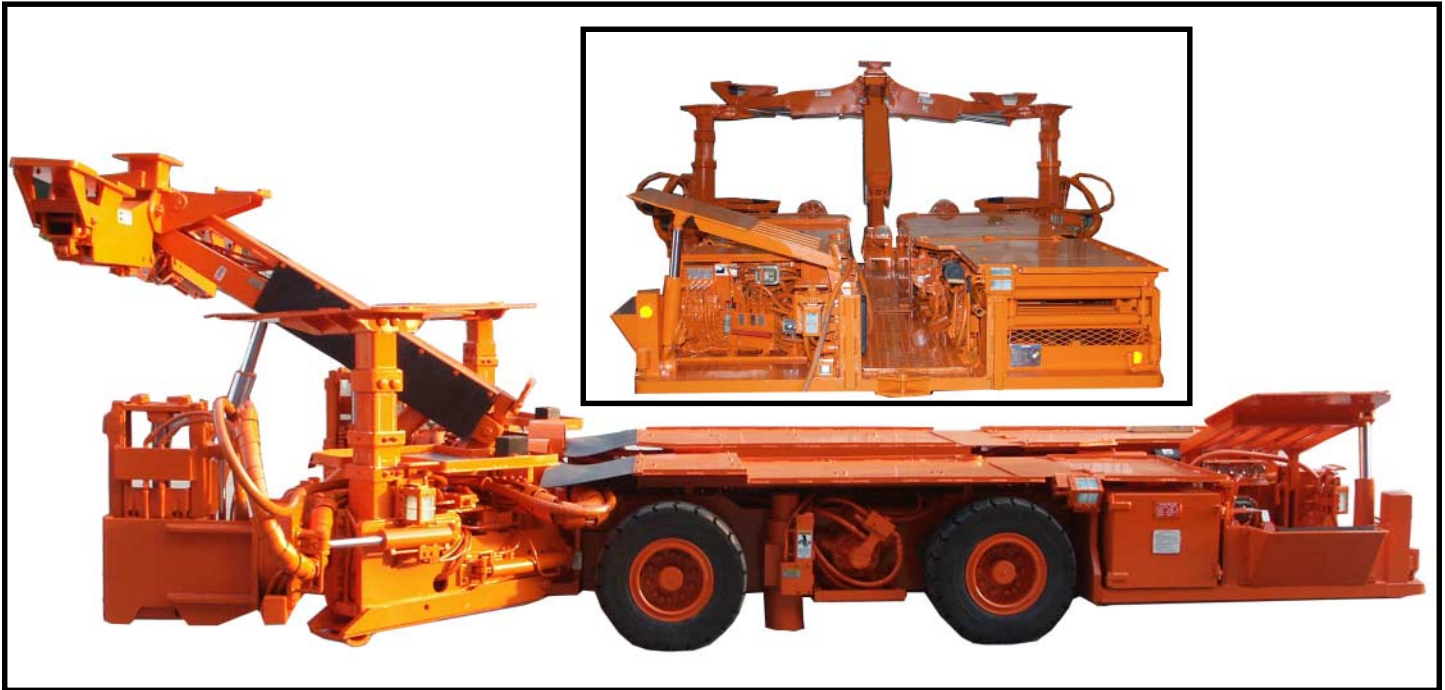

- **36" chassis height, dual head machine with angle drilling capability**
- **A truss and rib bolter that can also be used as a production bolter**
- **Walk through chassis design eliminates the need for the operator to walk between the machine and the rib.**

With Fletcher model DDR Walk-Thru, you get dual head, angle or vertical drilling in lower seams than ever. Model DDR offers a maximum straight line boom swing of 18 ft. to accommodate a 4 bolt pattern on 4 ft. centers. Masts tilt 45 degrees for truss installations; 90 degrees for tramming.

### Standard Equipment

Automatic Disc Brakes  
Fletcher Dust Tanks  
Four-Wheel Drive  
High Pressure Filters  
JIC Hose Fittings  
Front Lift  
Adjustable Bolt Torquing and Thrust Control  
Cable Reel  
Intrinsically Safe Panic Bars  
Tram Deck Canopy  
Drill Canopies  
Joystick Drill Controls  
Fire Suppression System

### Features

Maximum Straight Line Swing	18'	5.5m
Overall Length	25'2"	7.7m
Overall Width	10'6"	3.2m
Overall Chassis Height	36"	.9m
Wheelbase	72"	1.8m
Weight	42,000 lbs.	19050 Kg

(Dimensions and weight vary, depending on tire size and seam height application)

# Model DDR Walk-Thru Chassis

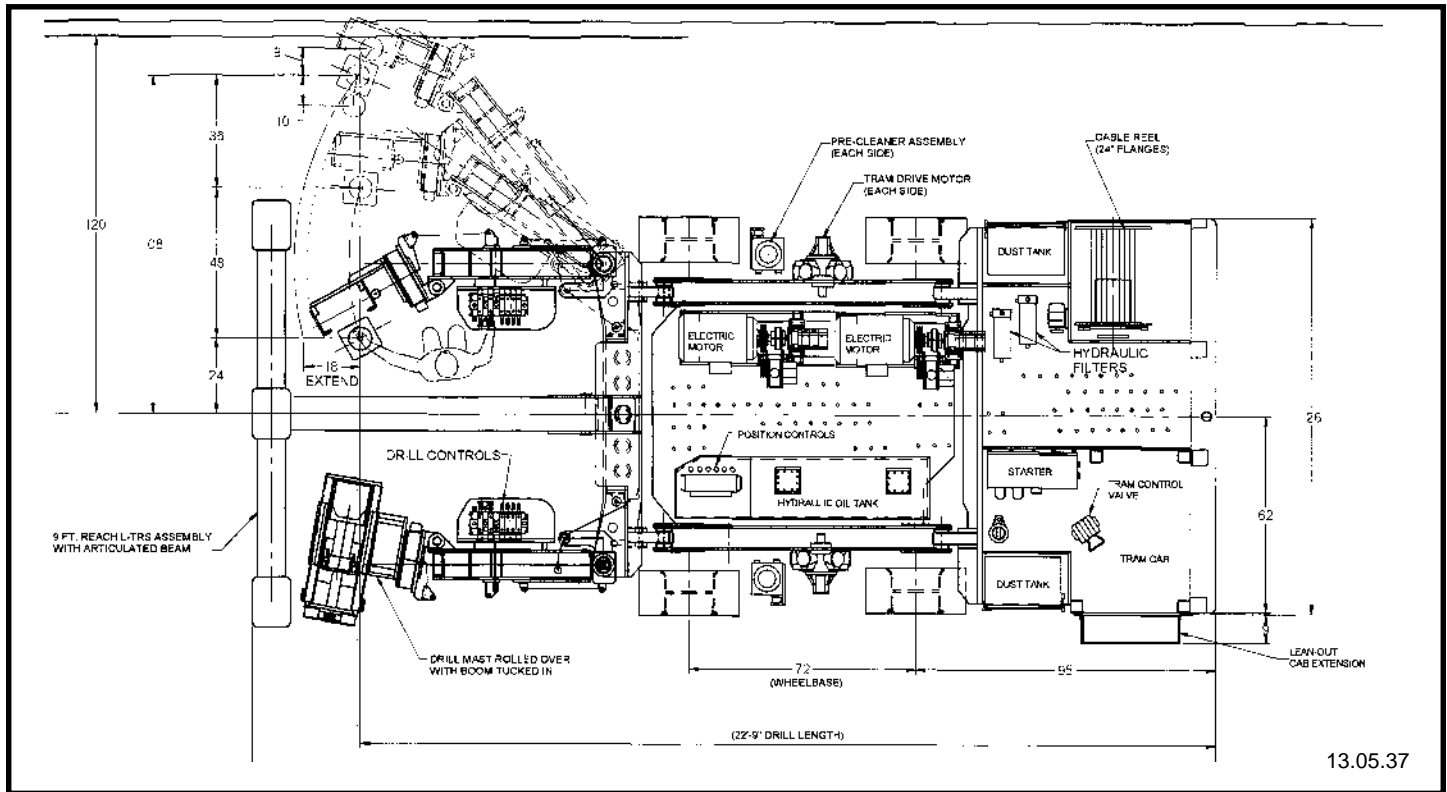

## General Specifications

**ELECTRICAL SYSTEM:** U.S.B.M. permissible dual 50 HP motors, horizontal axis cable reel; I.S. panic bars at drill and tram controls; MSHA approved illumination.

**DUST COLLECTION:** Internal through drill steel; blower: 62 cfm rotary lobe type; vacuum at drillhead: 12"-15" Hg; Fletcher dust tanks.

**HYDRAULIC SYSTEM:** maximum working pressure: 2800 psi; tank capacity - 125 U.S. gallons; filtration: (4) magnetic in-tank, (2) high pressure, hand operated fill pump with screened intake; hose fittings: JIC and SAE; dual Parker P350/315 Series pumps.

**DRIVE SYSTEM:** four wheel chain type; tractor steering; turns within length; tram speed: 0-1.5 mph; tram motors: Staffa B80 series with motion control valves; brakes: automatic spring set/hydraulic release disc; tires: 14.5 X 15 foam filled; front lift.

**SAFETY SYSTEM:** L type TRS; driller canopies; tram deck canopy.

**DRILLING SYSTEM:** linear sumping booms; Apollo telescoping mast feed; thrust: 8,000 lbs.; feed length: 51" to 81" depending on mast size; torque: 0-300 ft. lbs.; drill rotation speeds: 0-560 rpm; feed rate: 0-36 fpm; boom extend: up to 22"; minimum drill head separation: 4'; maximum drill head separation: 20'; adjustable bolt torquing valve; foot type boom stabilizers.

## Fletcher Options

- feedback drilling system
- I.S. plug in start controls
- Titan drill mast (10,000 lbs thrust)
- rotary impact drillheads
- hydraulic drill guides
- articulating TRS beam
- 5 bolt pattern capability
- Heavy duty tram w/36" tires
- power extend TRS beam
- auto dump pre-cleaners
- hydraulic power takeoff
- downhole drilling attachment
- crawler mounted
- radio remote control tram
- trailing cable limit control
- 11 ft. L-TRS assembly
- quick change motor mounts
- MSHA approved illumination
- rock dusters
- headlights
- adjustable wear pad support posts
- operator cooling fans
- venturi or motor oil fill

J. H. Fletcher & Co. cannot anticipate every mine hazard that may develop during use of these products. A roof control plan must be approved by MSHA before use of these products begins. Proper use, maintenance and continued use of (OEM) original equipment parts will be essential for maximum operating results.

*Specifically engineered for each customer's needs.*



**J. H. Fletcher & Co.**  
 402 High St. P.O. Box 2187  
 Huntington, WV 25722-2187  
 jhf@jhfletcher.com